

OXYGEN MASKS - MAINTENANCE PRACTICES

1. General

- A. The Model 208 is equipped with one pilot's mask and nine passenger masks. The pilot's mask has a built-in microphone. On Models 208 and Federal Express 208B pilots and copilots quick-don masks with built-in microphones are provided. The Model 208 Super Cargomaster and 208B Passenger masks are of the constant-flow type with a metering orifice in the quick-connect adapter. The Model 208 and Federal Express 208B masks are the demand type. A flowmeter built into the line approximately 6 inches from the connector provides a visual indication of proper oxygen flow, showing red when no flow is taking place, red and green with a partial flow, and green with full flow. The masks are color-coded by a blue sleeve adjacent to the quick-connect adapter.

2. Oxygen Mask Inspection

- A. Inspect Oxygen Mask (Refer to Figure 201).
 - (1) Check oxygen masks for cracks and rough face seals.
 - (2) Flex the mask hose gently over its entirety and check for evidence of deterioration or dirt.
 - (3) Examine mask and hose storage compartment for cleanliness and general condition.
 - (4) Observe that each mask breathing tube end is free of nicks and that the tube end will slip into the cabin oxygen receptacle with ease and will not leak.
 - (5) If a mask assembly is defective (leaks, does not allow breathing, or contains a defective microphone) it is advisable to return the mask assembly to the manufacturer or a repair station.
 - (6) Replace hose if it shows evidence of deterioration.

3. Oxygen Mask Cleaning

- A. Clean Oxygen Mask.
 - (1) Clean and disinfect mask assemblies after use with rubbing alcohol, as appropriate.
 - (2) If installed, remove microphone from mask.
CAUTION: DO NOT ALLOW RUBBING ALCOHOL TO ENTER MICROPHONE OR ELECTRICAL CONNECTIONS.
 - (3) Apply rubbing alcohol to mask with a cotton swab or the equivalent, as required, to remove contamination.
 - (4) If used, install microphone.

Figure 201 : Sheet 1 : Mask Assembly and Smoke Goggles

A22292

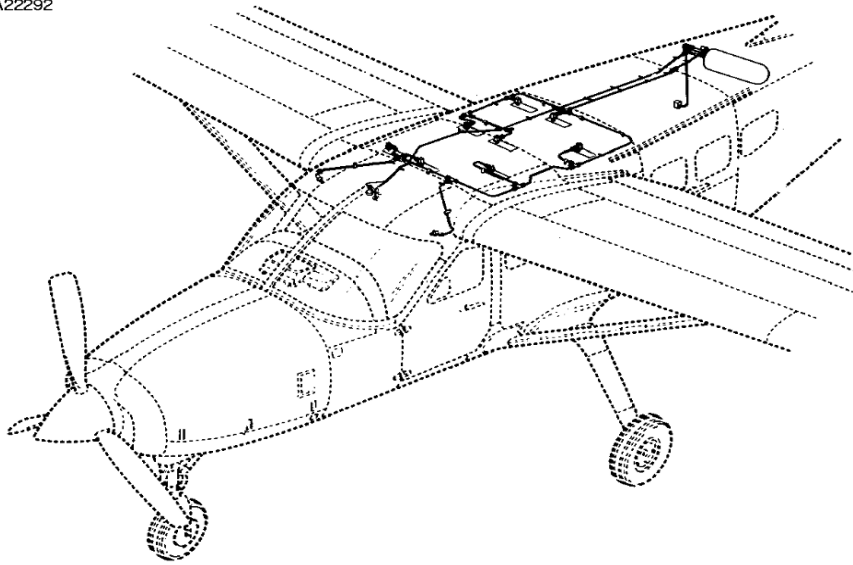

TEN-PORT SYSTEM
MODEL 208 ONLY

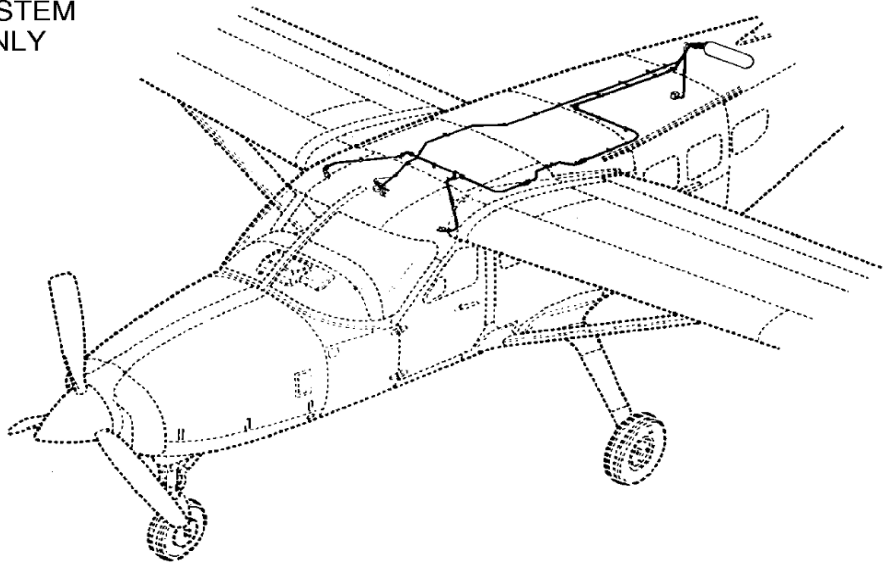

TWO-PORT SYSTEM

1 (NOTE)

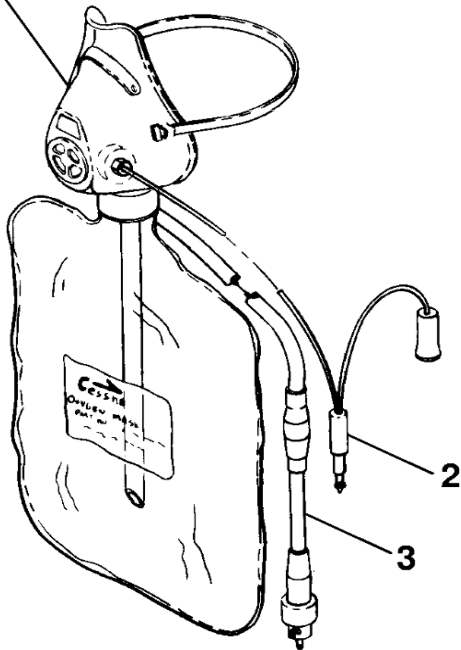

1. MASK ASSEMBLY (**NOTE**)
2. MICROPHONE CABLE (PILOT ONLY)
3. LINE AND ADAPTER ASSEMBLY

NOTE: USED WITH PRESSURE
COMPENSATED SYSTEM ONLY.

MODELS 208 CARGOMASTER,
SUPER CARGOMASTER AND
208B PASSENGER

26141046
26141043
26141031

Figure 201 : Sheet 2 : Mask Assembly and Smoke Goggles

A22293

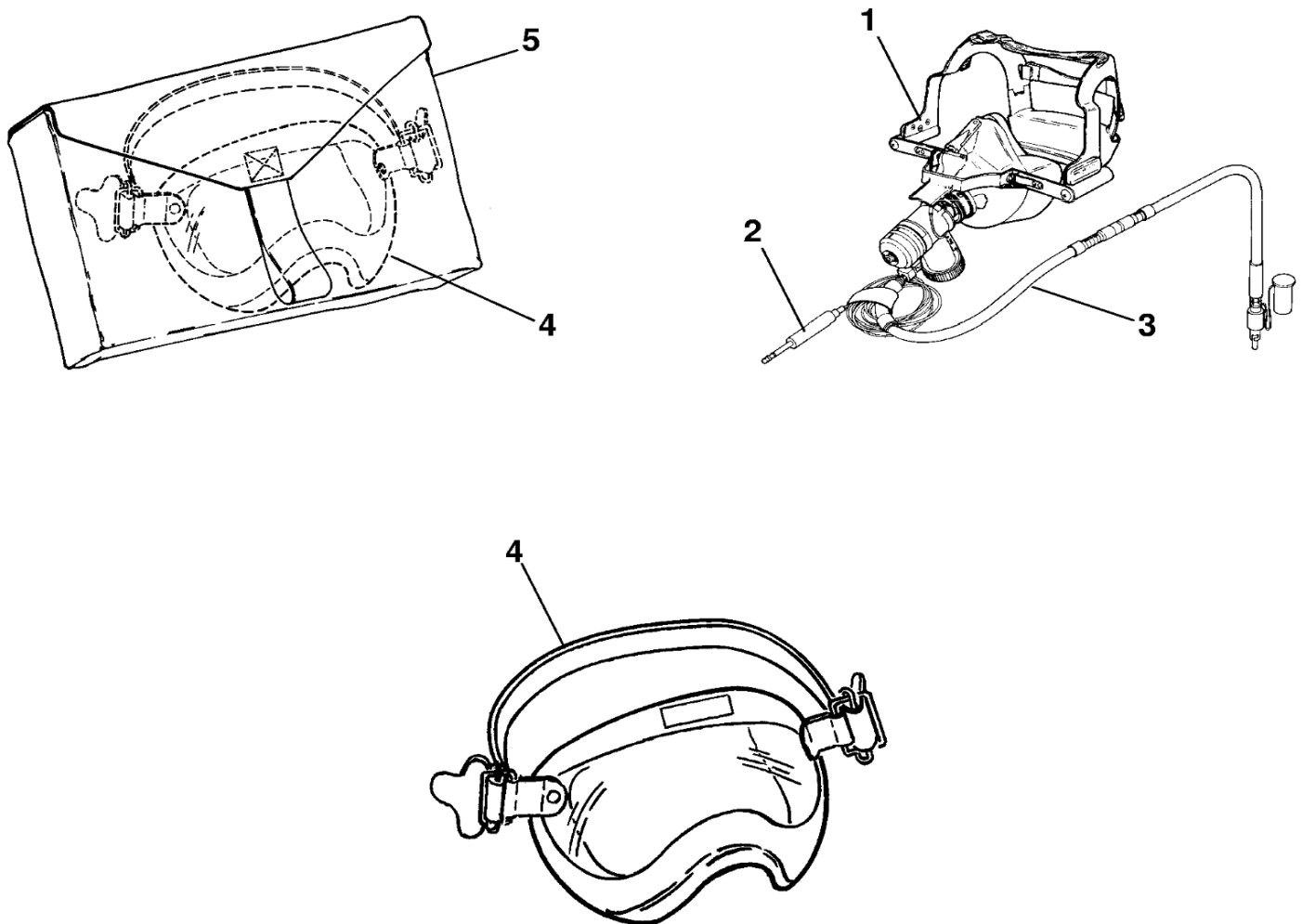

1. OXYGEN MASK
2. MICROPHONE CABLE
3. LINE AND ADAPTER ASSEMBLY
4. SMOKE GOGGLES
5. SMOKE GOGGLES CASE

FEDERAL EXPRESS 208B
(NOT APPLICABLE TO 208 CARGOMASTER
OR SUPER CARGOMASTER)

26141025
26142010
26141211

Figure 201 : Sheet 3 : Mask Assembly and Smoke Goggles

A22294

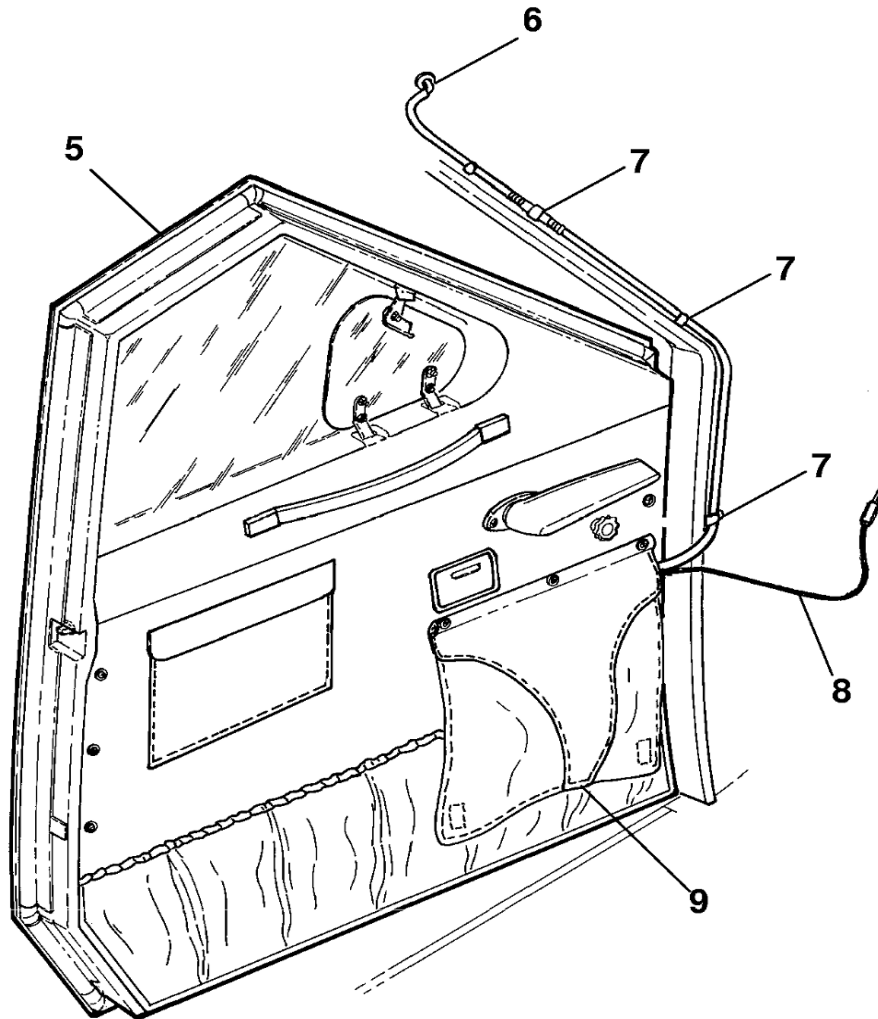

TYPICAL BOTH DOORS

- 5. LEFT CREW DOOR
- 6. OXYGEN OUTLET
- 7. CLIP
- 8. MICROPHONE CABLE
- 9. POCKET (OXYGEN MASK)

MODEL 208 AND FEDERAL EXPRESS 208B

2614M2009